

## Focke Wulf Fw 189B Uhu 'Trainer'

1/72

### CZ

Německá Luftwaffe před druhou světovou válkou používala k taktickému průzkumu letouny zastaralé hornoplošníky Heinkel He 46 a o něco modernější hornoplošníky Henschel He 126. Ani ty nedávaly záruku bezpečnosti při setkání se stíhačkami nepřítele. Proto RLM vypsal soutěž na nový taktický průzkumný letoun. Zúčastnily se jí firmy, Arado (Arado Ar 198), Blohm Voss (Blohm Voss BV 141) a Focke Wulf (Focke Wulf Fw 189). Celokovový dvoumotorový letoun s centrální gondolou a dvěma nosníky ocasních ploch se ve verzi Fw 189A stal standardním taktickým průzkumným letounem Luftwaffe. Používán byl celou válku a dostal se i do výzbroje letectev některých německých spojenců. Firma Focke Wulf a její šéfkonstruktér ing Kurt Tank se snažili uplatnit tento letoun i v jiných rolích. Tyto verze se ale nedočkaly takového rozšíření. RLM po úspěšných zkouškách prvních tří prototypů v roce 1937 objednalo další prototypy. Požadovalo stavbu dalších prototypů již testované průzkumné verze a prototypy cvičné verze, bitevní verze a cvičné námořní verze, vybavené plováky.

Prototyp Fw 189V-5 byl postaven jako vzor verze Fw 189B pro výcvik posádek vícemotorových letadel. Dostal zcela novou trupovou gondolu se stupněnou přídílí. Gondola byla pětimístná. Pilotní sedadla umístěná vedle sebe byla vybavena dvojím řízením. Stejně jako předchozí prototyp průzkumné verze Fw 189V-4 měl Fw 189V-5 namontovány jednoduché nohy podvozku a gondoly motorů Argus As 410 byly na levé straně osazeny nasavači. Zatímco sériové stroje Fw 189A byly vyráběny s dvojitými nohami podvozku a jejich motory neměly boční nasavače, pro verzi Fw 189B se tyto prvky staly standardem. Po prototypu V-5 byly postaveny další dva kusy před sériové verze B-0. Po nich bylo postaveno deset sériových cvičných Fw 189B-1. Dodány byly do konce února 1940. Sloužily jako cvičné a spojovací, ale podrobnosti o jejich službě nejsou známy.

Bitevní verze Fw 189C byla postavena jen v prototypech Fw 189V1b a Fw 189V-6. Prototyp plovákové verze Fw 189D označený V-7 nebyl dostavěn.

rozpětí: 18,4 m, délka: 12,20 m, max. rychlost: 325 km/h, dolet: 670 km, praktický dostup: 7300 m.

### EN

In the pre-war years, the German Luftwaffe operated for tactical reconnaissance the already rather obsolete Heinkel He 46 and Henschel He 126 parasols, the latter, even being of a bit more modern design, was not safe during an encounter with the enemy's fighter planes. So, the RLM issued a contest for a new tactical reconnaissance aircraft in which companies Arado (with the Arado Ar 198), Blohm Voss (Bv 141) and Focke Wulf (with their Fw 189) took part. The Fw 189, a twin-engined, all metal construction aircraft with a central fuselage nacelle and two tail booms won the competition and eventually became the Luftwaffe's standard tactical recon platform. The Fw 189 saw service with the Luftwaffe throughout the war and was also used in the air forces of some German satellite countries. The Focke Wulf company and its chief designer Kurt Tank also intended to find other use for the aircraft, the emerging versions, however, would not find such wide use. Following the successful trials of the first three prototypes in 1937, the RLM had ordered several more prototypes, demanding yet one more in the recon configuration and also a trainer version, ground attack version and a maritime trainer fitted with a pair of floats.

The Fw 189V-5 prototype was built as a first specimen for the Fw 189B version which was to serve for multiple engine aircraft crew training. The plane was fitted with a completely new fuselage nacelle with a stepped-off nose. The nacelle housed five seats, the two pilots sat side by side and both had a full set of controls. The V-5 prototype, like the previous one, the V-4 recon version prototype, featured a single undercarriage leg on either side and the Argus Ar 410 engine nacelles had air intakes on the left hand side. Whilst the production Fw189As were fitted with double legs in either nacelle and no side intakes, those features became a standard for the Fw189B version. Following the V-5 prototype, two more were built in the pre-production B-0 batch, followed by ten more Fw189B-1 training aircraft. Being delivered by the end of February 1940, they saw service in the training and liaison roles, with no more information of their career available.

The Fw 189C ground attack version was built only in two prototypes, the Fw189V1b and Fw 189V-6. The V-7 prototype of the Fw189D floatplane version was never finished.

Span: 18.4 m, length: 12.20 m, max. speed: 325 km/h, range: 670 km, service ceiling: 7,300 m.

# PLASTIC PARTS

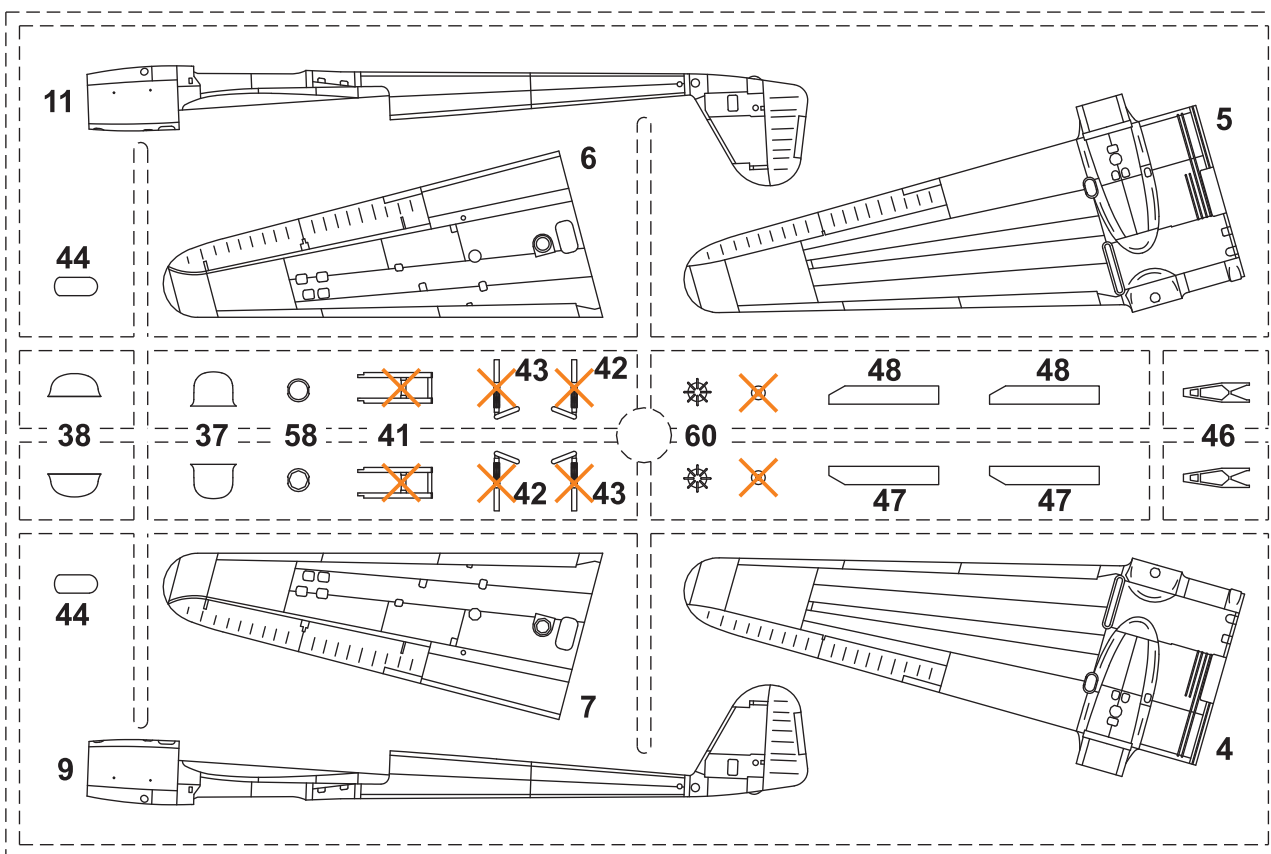
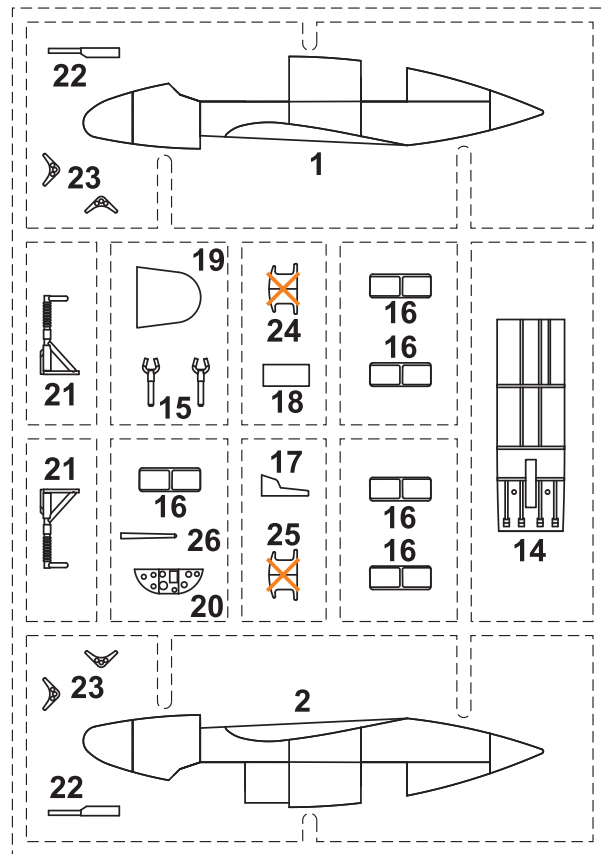
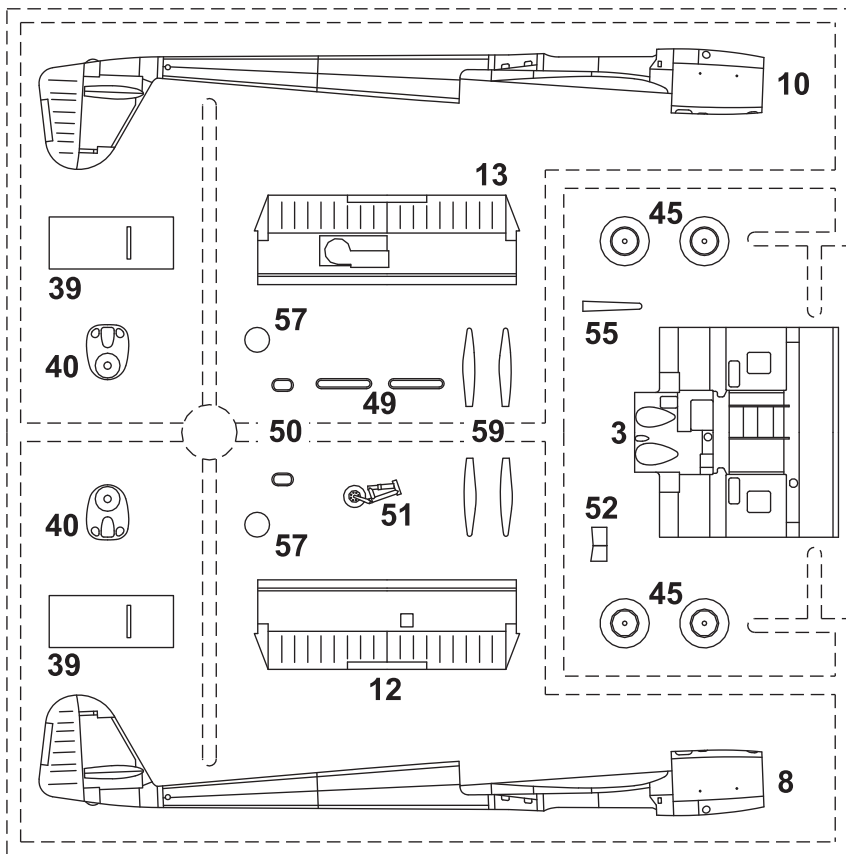

## POLYURETHAN PARTS (PUR)

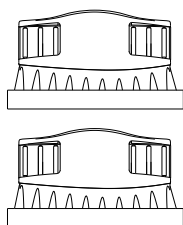

## CLEAR PARTS (CP)

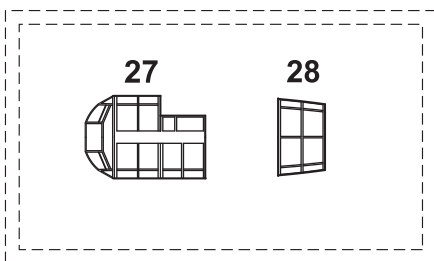

<b>A</b>	Šedá RLM 02 / GREY RLM 02	H70 / C60
<b>B</b>	Černošedá RLM 66 / BLACK GREY RLM 66	H416 / C116
<b>C</b>	Černozelená RLM 70 / BLACK GREEN RLM 70	H65 / C18
<b>D</b>	Černá / BLACK	H12 / C33
<b>E</b>	Barva pneu / TIRE BLACK	H77 / C137
<b>F</b>	Stříbrná / SILVER	H8 / C8

Barvy GUNZE / GUNZE Colour No.

**SYMBOLS**

**?** MOŽNOST VOLBY  
OPTIONAL  
NACH BELIEBEN  
OPTION

**👉** POUŽIT KYANOAKRYLÁTOVÉ LEPIDLO  
INSTANT CYANOACRYLATE GLUE  
ZYANOAKRYLATKLEBER  
COLLE CYANOACRYLAT

**↪** OHNOUT  
BEND  
BIEGEN  
COURBER

**👤** ZHOTOVIT NOVÉ  
SCRATCH BUILD  
FERTIGSTELLEN  
ACHEVER

**✂** ŘEZAT/VRTAT  
CUT OFF/DRILL  
ENTFERNEN  
DETACHER

**👉** NATŘÍT  
COLOUR  
FARBEN  
PEINDRE  
GSI colour code

**ASSEMBLY**

**1**

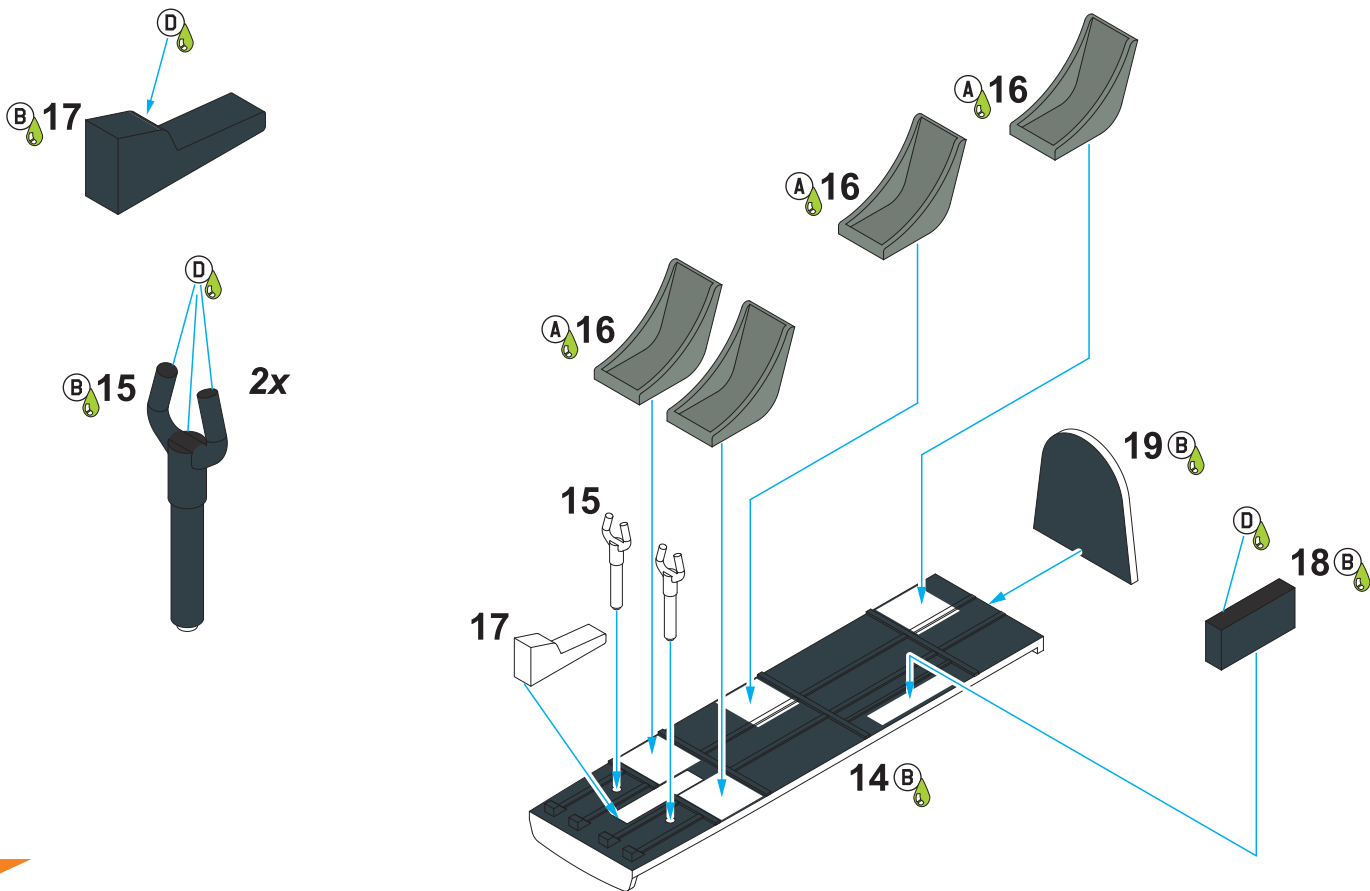

**2**

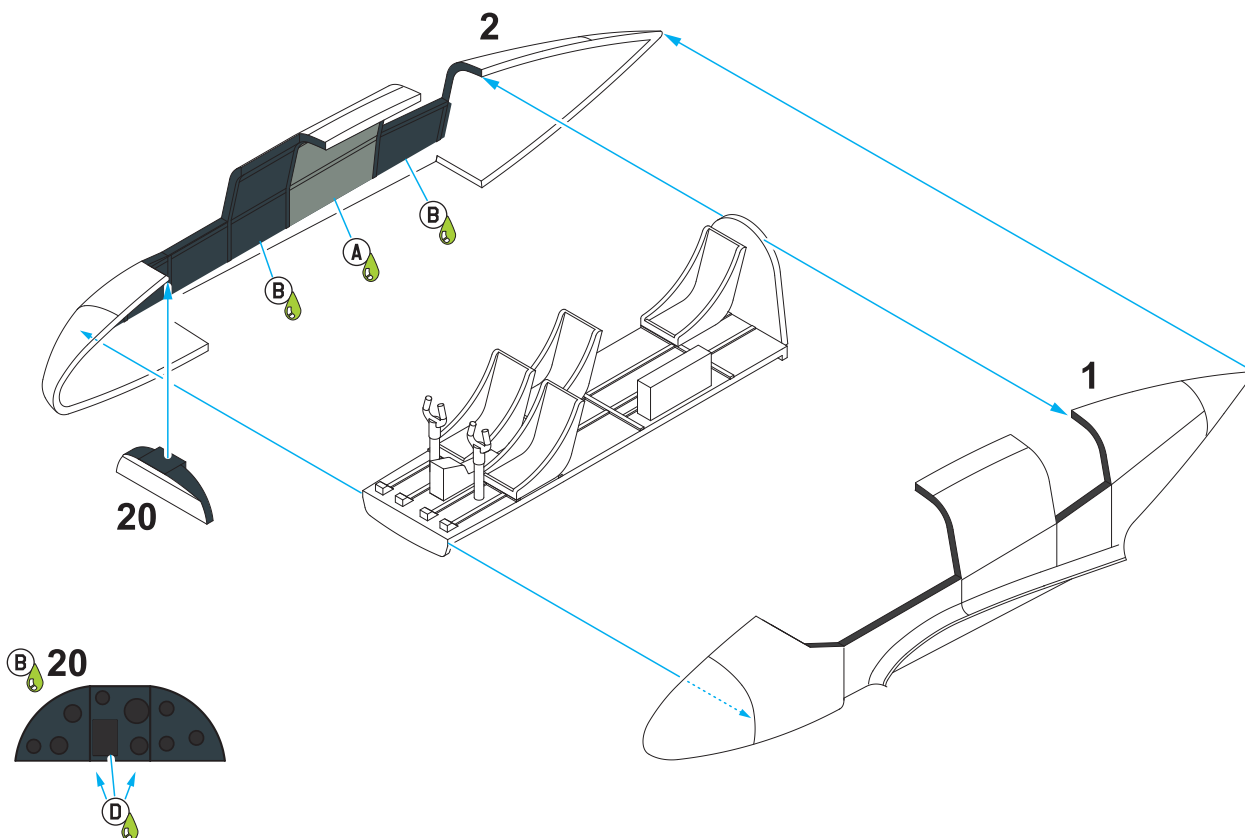

3

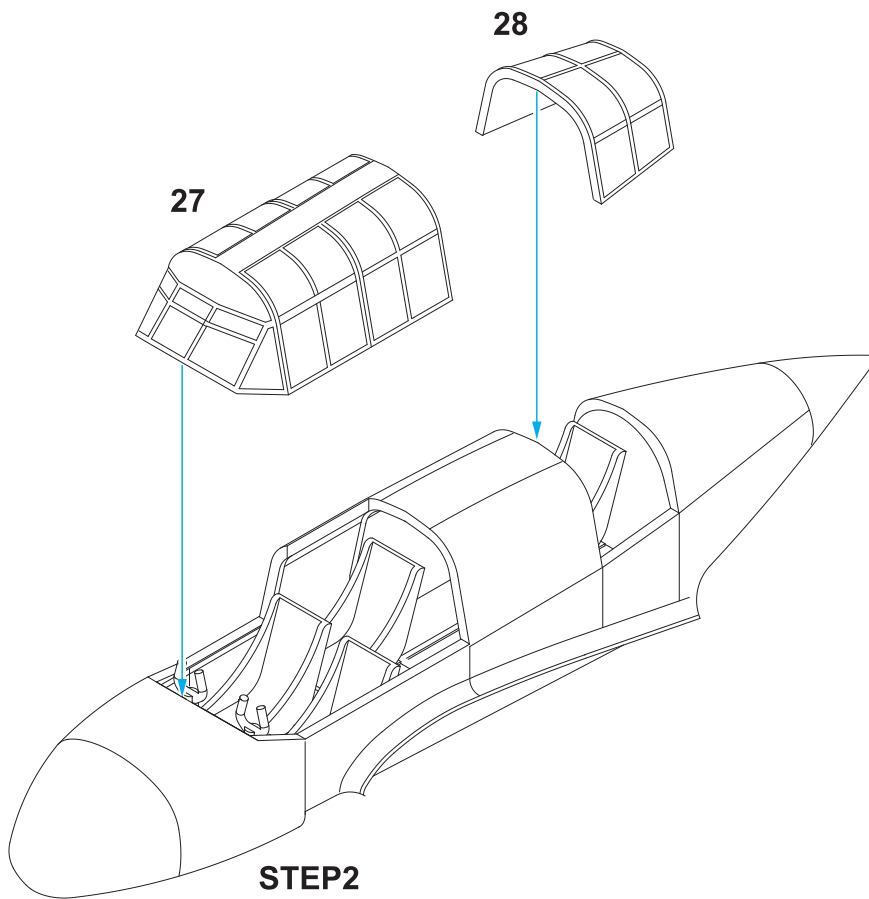

4 2x

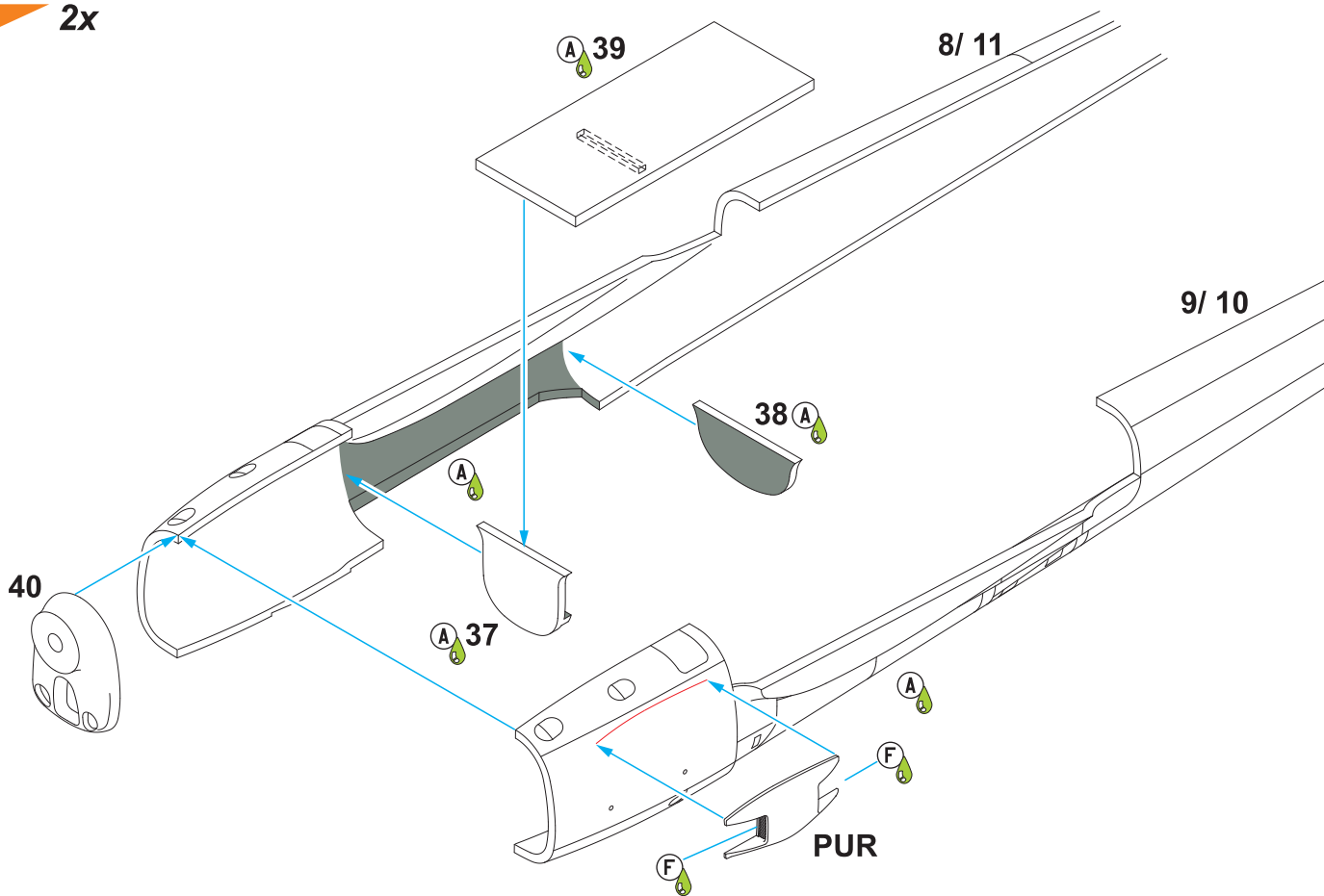

5

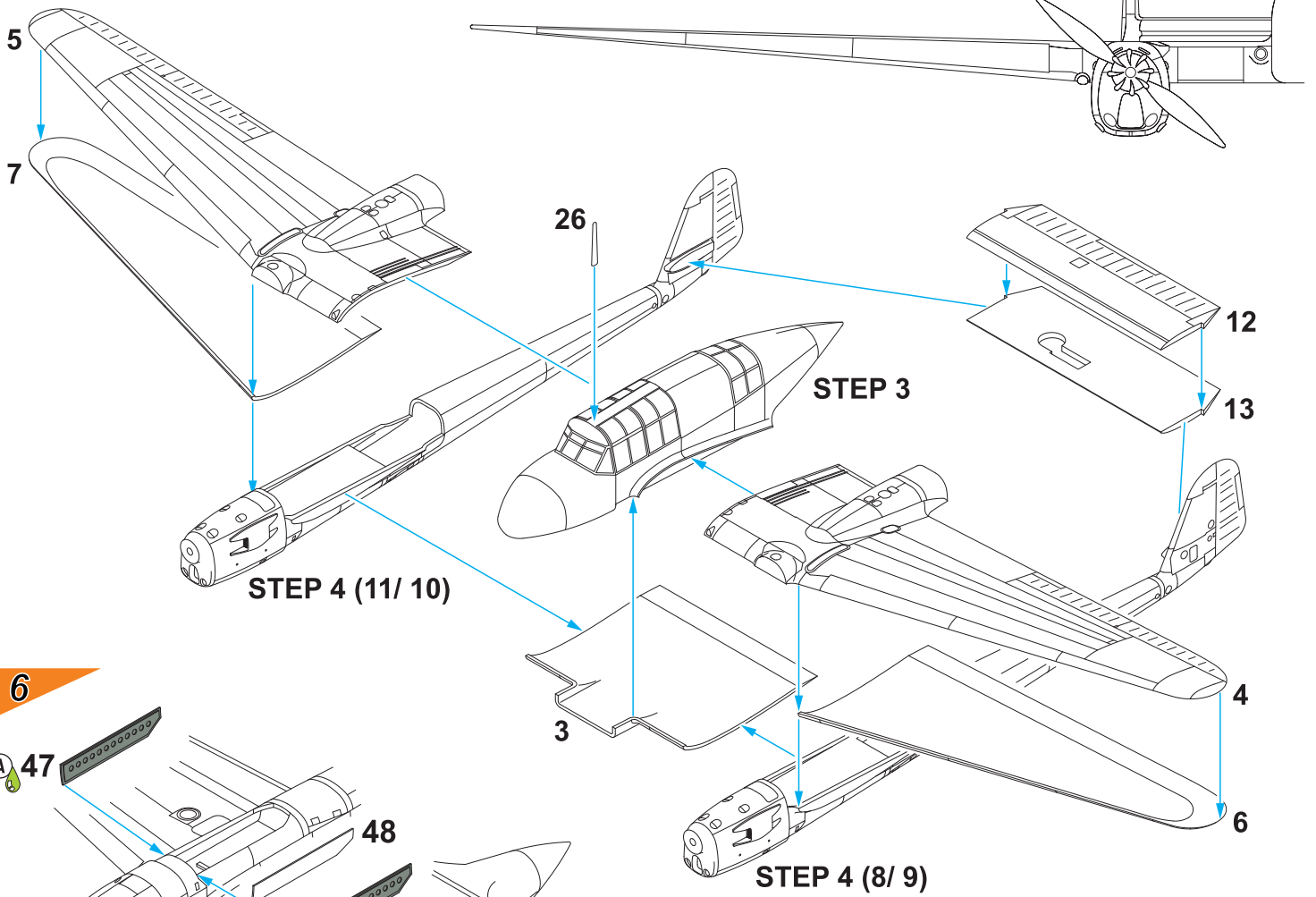

6

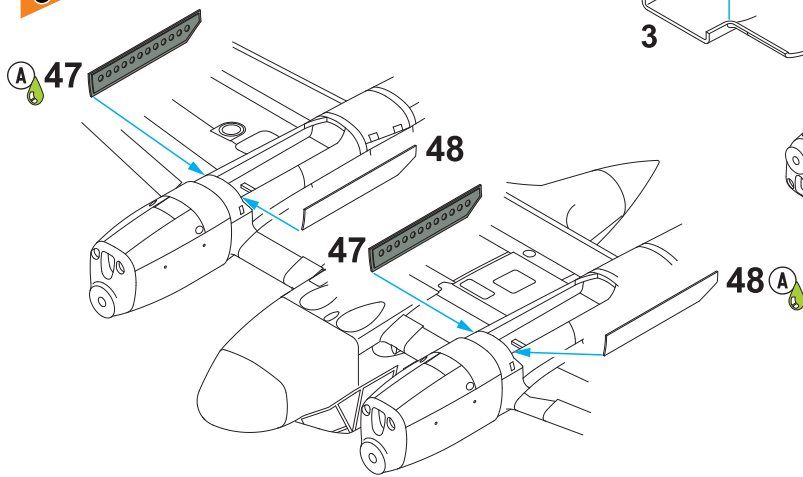

7

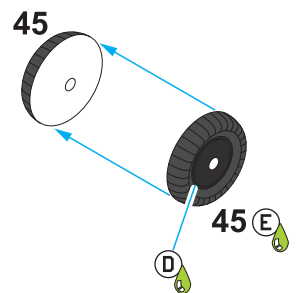

8

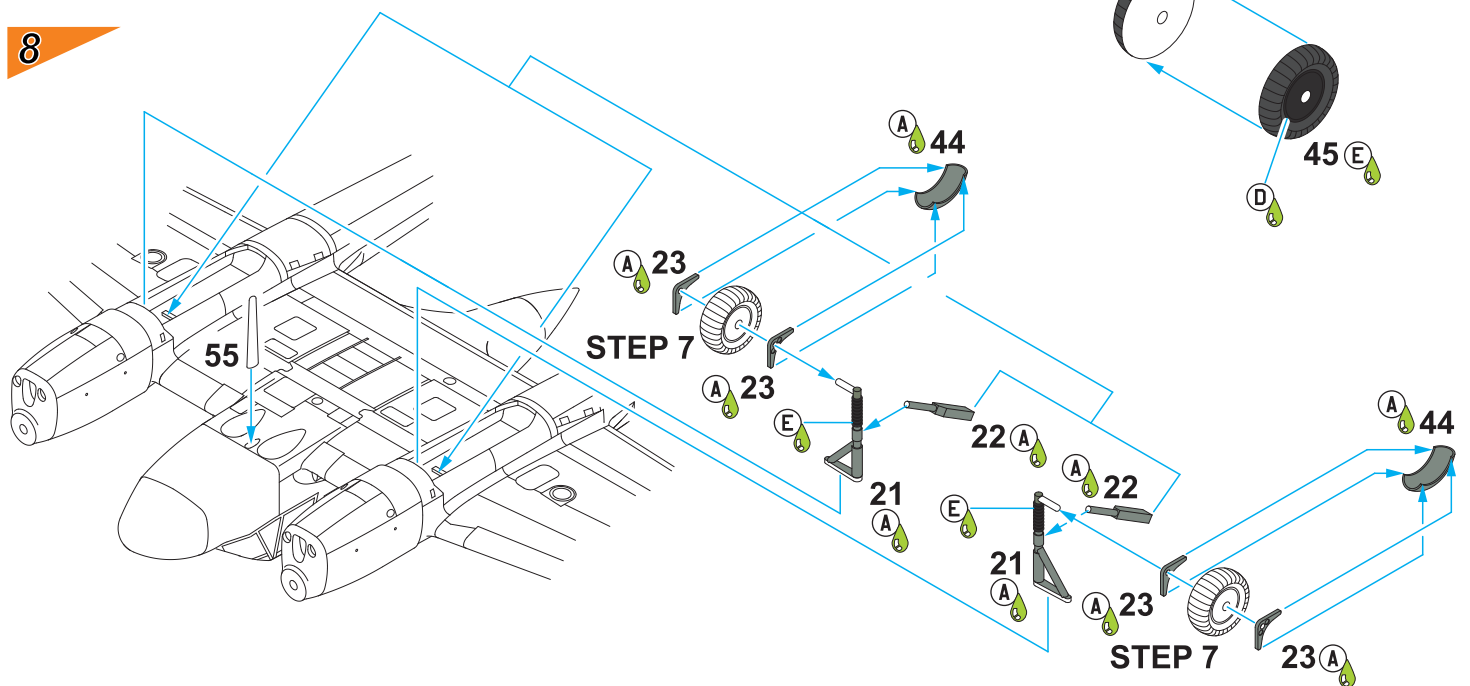



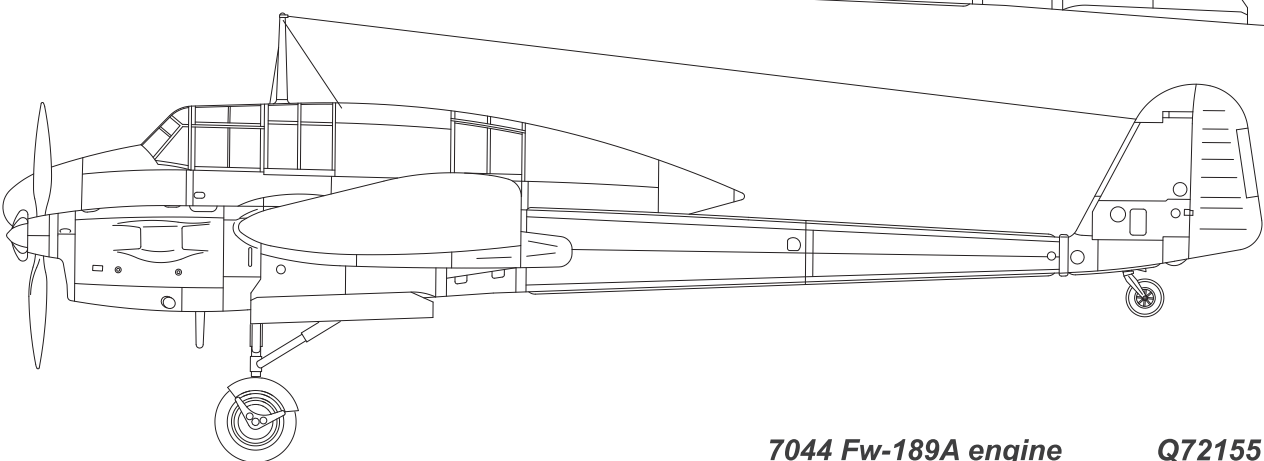
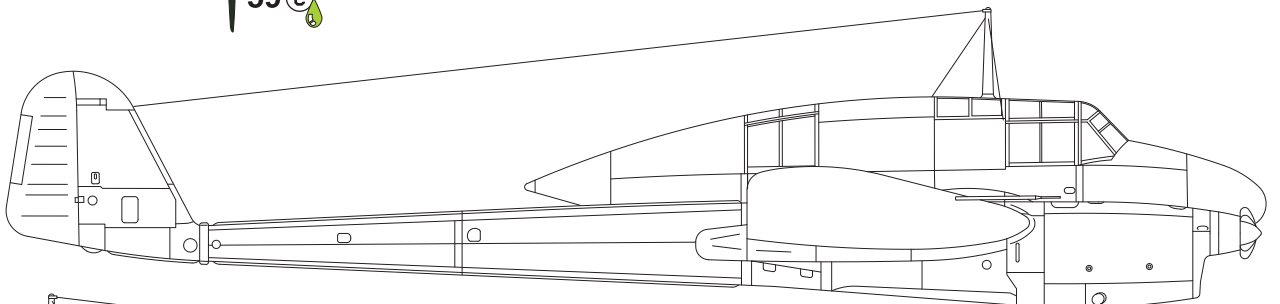
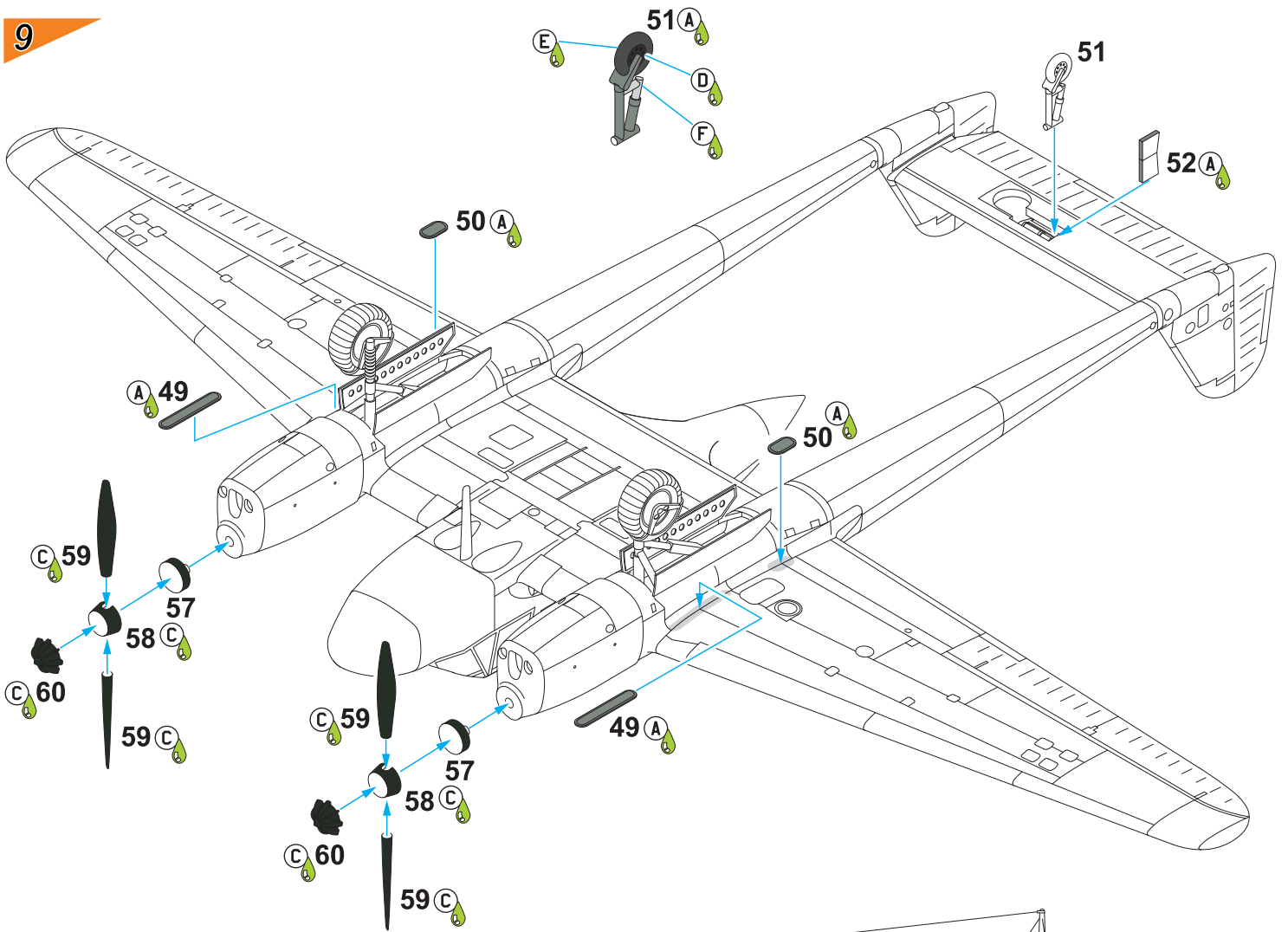

**Q72290 Fw 189A Corrections Propellers for SH/ICM**



**Q72284 Fw 189A-1/-2 Mainwheels Set for SH/ICM**



**7044 Fw-189A engine set for SH/CON (Argus 410)**

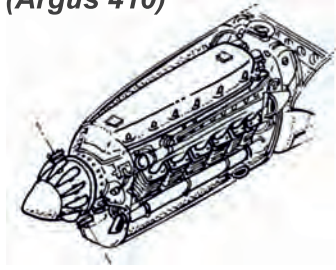

**Q72155 Focke Wulf Fw 189A/B/V-6 Tail planes for MPM/SH**

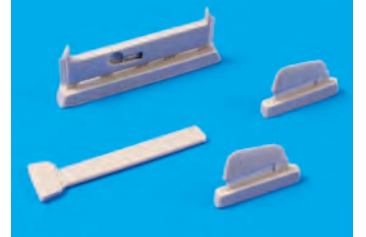

Focke Wulf Fw 189B-0, W.Nr. 0010, BQ+AZ, pravděpodobně tovární letiště firmy Focke Wulf, Brémy, 1940. Některé publikace uvádějí, že stroje série B-0 nebyly vybaveny lapači na motorových gondolách. Fotografie ale ukazují, že BQ+AZ měl lapače na levých stranách obou motorových gondol instalované.

Focke Wulf Fw 189B-0, W.Nr. 0010, BQ+AZ, probably at the Focke Wulf factory airfield, Bremen, 1940. Some references say the B-0 series machines did not have the engine nacelle air intakes. Available photographs show, however, BQ+AZ being fitted with these on the port side of the nacelles.

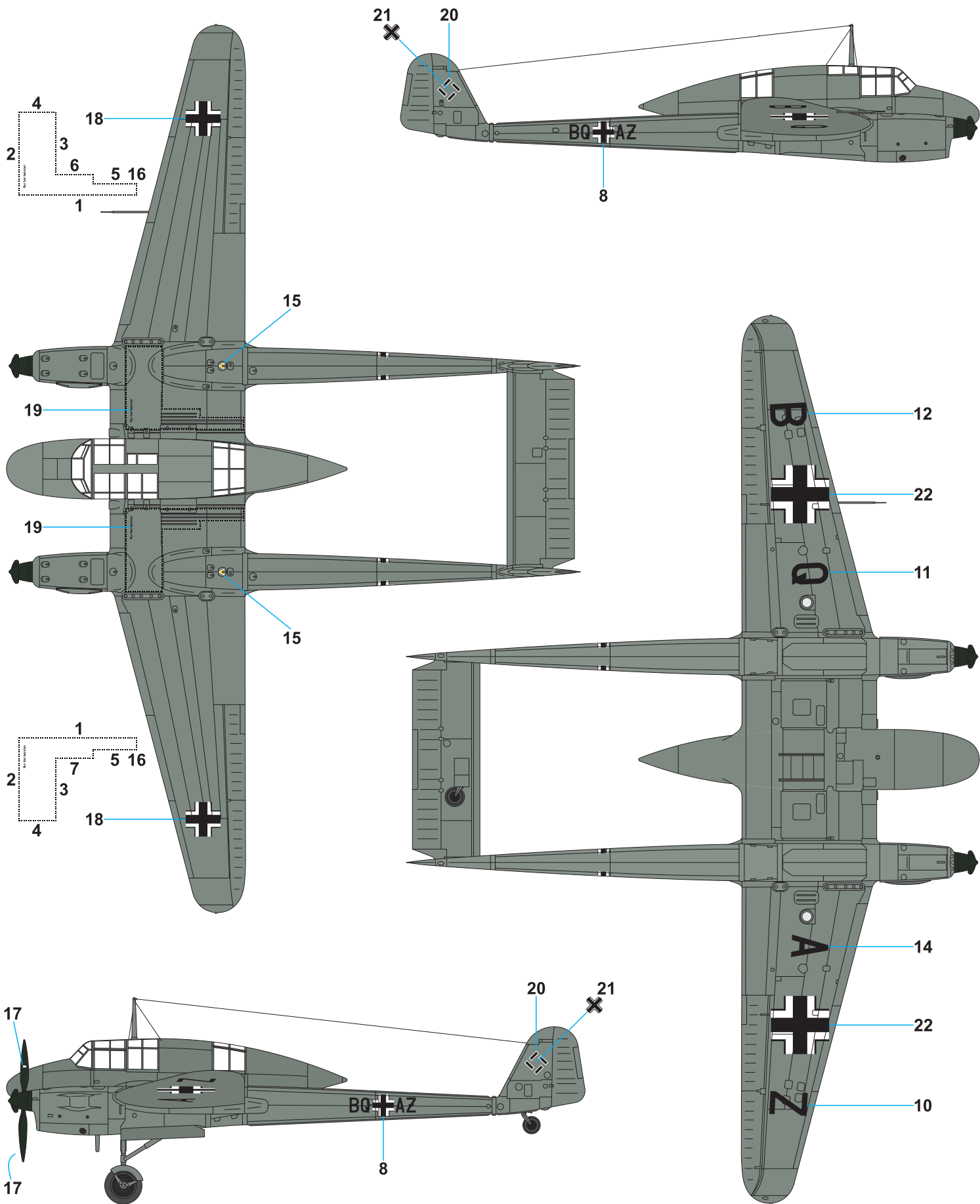

● Šedá  
 Grey  
 RLM 02 H70/C60

Focke Wulf Fw 189B-1, W.Nr. neznámý, BS+AA, jeden z deseti sériových kusů této verze, 1940.

Focke Wulf Fw 189B-1, W.Nr. unknown, BS+AA, one of only ten production machines built in this version, 1940.

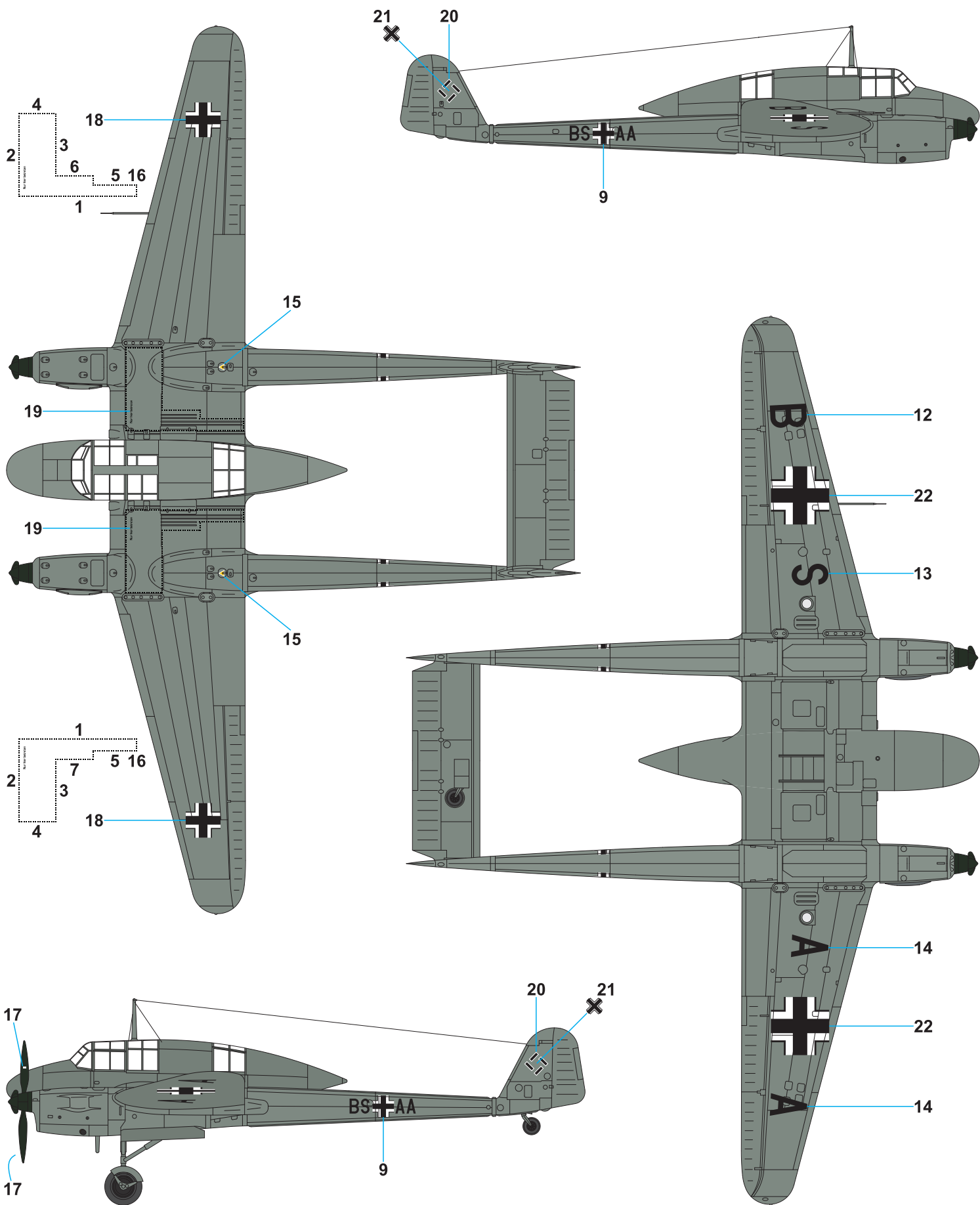

Šedá  
Grey  
RLM 02 H70/C60



Focke Wulf Fw 189B-1, W.Nr. neznámý, BS+AC, jeden z deseti sériových kusů této verze, 1940. Tento kamuflovaný stroj byl vyfocen na letišti Prag-Rusin v Protektorát Böhmen und Mähren (okupovaném Československu), tedy na nynějším pražském letišti Václava Havla.

Focke Wulf Fw 189B-1, W.Nr. unknown, BS+AC, one of only ten production airframes built in the B-1 version, 1940. The camouflaged machine was photographed at Prag-Rusin air base in the Protectorate of Bohemia and Moravia (occupied Czechoslovakia), today's Vaclav Havel Airport Prague.

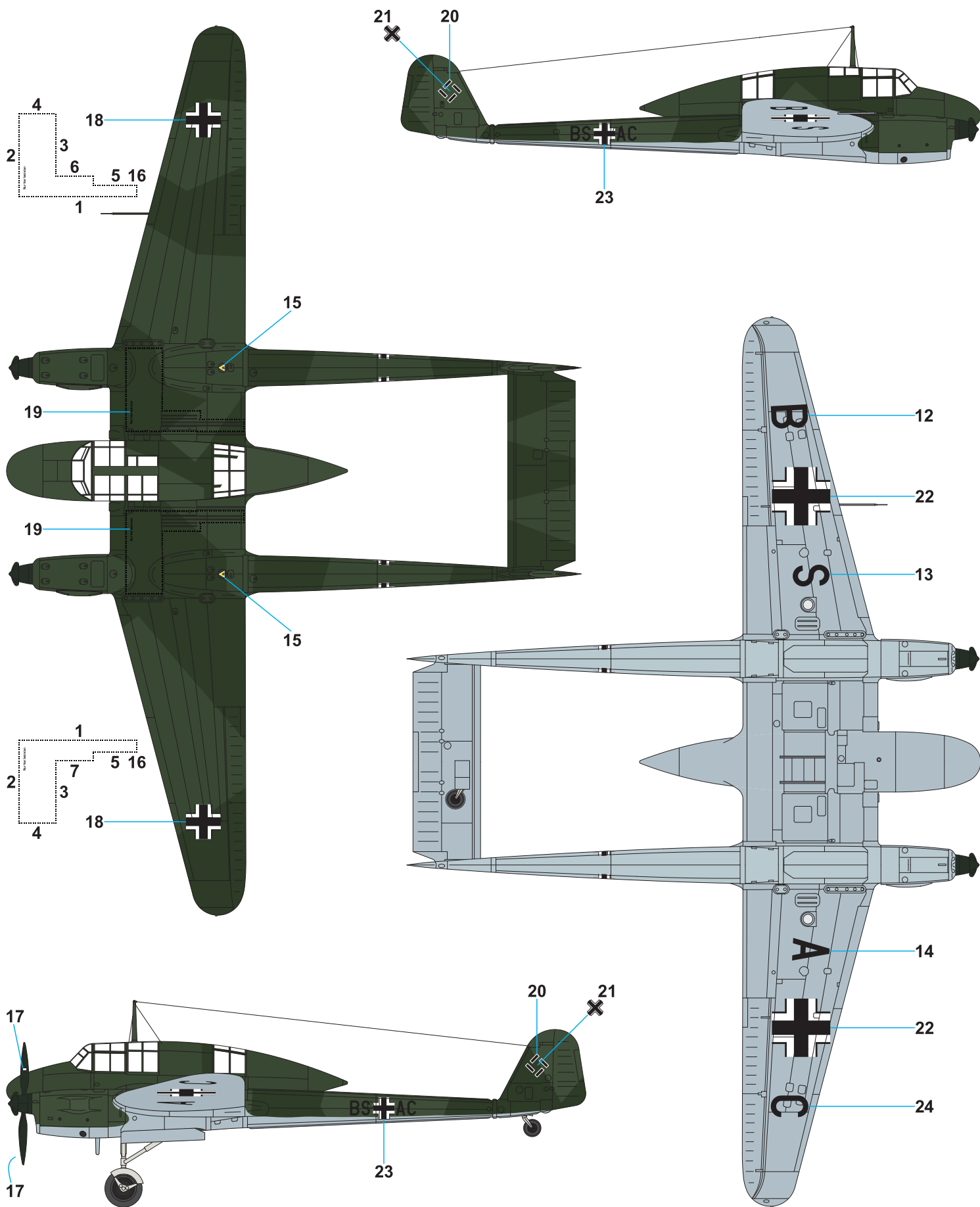

Černo zelená  
Black Green  
RLM 70 H65/C18

Tmavá zelená  
Dark Green  
RLM 71 H64/C17

Světlé modrá  
Light Blue  
RLM 65 H67/C115

New range of outstanding  
Bf 109E kits in 1/72 scale

1/72  
SH72439

Messerschmitt  
Bf 109E-3

Special  
MASK

M72010  
Bf 109E-3

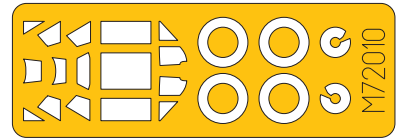

1/72 SH72439  
Messerschmitt  
Bf 109-E4

K72031  
German Ace Helmut Wick's Bf 109E-4 Decals

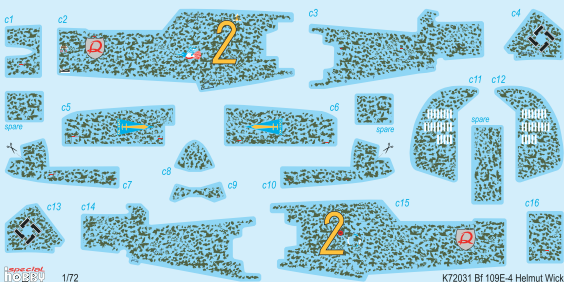

Special  
MASK

M72009  
Bf 109E-4

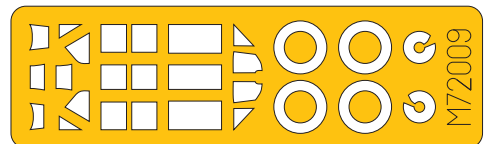

Special  
HOBBY

facebook.com/specialhobby  
WWW.SPECIALHOBBY.EU | WWW.CMKKITS.COM

CMK  
CZECH  
MASTER'S KITS



# Messerschmitt Bf 109E

## CMK RESIN SETS

for Special Hobby kits



129-7457  
Messerschmitt Bf 109E  
Wing Guns



129-7461  
ESK 2000 B German WWII  
Gun Camera



129-Q72384  
Messerschmitt Bf 109E  
Wheels



129-7458  
Messerschmitt Bf 109E  
FuG VII Radio Equipment



129-Q72389  
Messerschmitt Bf 109E  
Propeller Hub and Spinner  
Detail Set



129-Q72390  
Messerschmitt Bf 109E  
Exhausts

129-7455  
Messerschmitt Bf 109E Engine

129-7456  
Messerschmitt Bf 109E Fuselage Machine Guns and Ammo Boxes

129-Q72385  
Messerschmitt Bf 109E-4/B SC500 Bomb and Rack



1/72  
SH72442

# EoN Eton TX.I/SG-38 'Over West Europe'

Special  
**HOBBY**

STEFAN JIMMIX

SA72022

# Sd.An 115 Flatbed Trailer (Tank Transport)

PLASTIC KIT



**CMK**  
CZECH  
MASTER'S KITS



*Star Dust*  
weathering pigments



**The Razor Saw with Handle (cat. n. H1010) is a great tool for cutting both plastic and resin. CMK also offers a wide variety of coarse/medium/fine saws.**

**H1000** Ultra smooth and extra smooth saw  
(2 sides – 70 teeth / 42 teeth) 1 pc

**H1001** Ultra smooth saw  
(both sides – 70 teeth / 70 teeth) 1 pc

**H1002** Very smooth saw  
(both sides – 42 teeth / 42 teeth) 1 pc

**H1003** Smooth saw  
(both sides – 31 teeth / 31 teeth) 1 pc

**H1004** Ultra smooth and extra smooth saw  
(2 sides – 70 teeth / 42 teeth) 5 pcs

**H1005** Ultra smooth saw  
(both sides – 70 teeth / 70 teeth) 5 pcs

**H1006** Very smooth saw  
(both sides – 42 teeth / 42 teeth) 5 pcs

**H1007** Smooth saw  
(both sides – 31 teeth / 31 teeth) 5 pcs

**H1010** Razor Saw with Handle

Special  
**HOBBY**

[facebook.com/specialhobby](https://www.facebook.com/specialhobby)

[WWW.SPECIALHOBBY.EU](http://WWW.SPECIALHOBBY.EU) | [WWW.CMKKITS.COM](http://WWW.CMKKITS.COM)

**CMK**  
CZECH  
MASTER'S KITS